

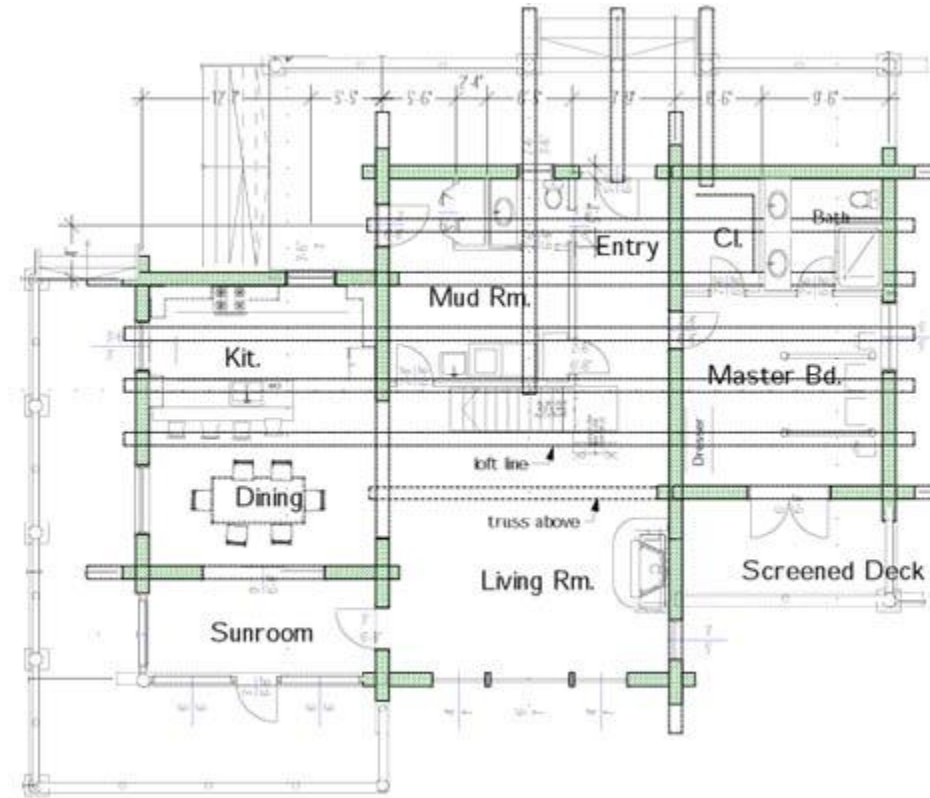

Nicholson



 <p>Cascade Handcrafted Log Homes</p>	Design:	Nicholson	Area:	2,700 sq ft (251 m ²)
	Designed by:	Taron Design	Features:	Sunroom off living room, screened porch off master bedroom, interior truss over living room, mudroom off entry.
	Log Home Construction Style:	Traditional Full Scribe		

Nicholson: Plan of 1st Floor



 <p>Cascade Handcrafted Log Homes</p>	Design:	Nicholson	Area:	2,700 sq ft (251 m ²)
	Designed by:	Taron Design	Features:	Sunroom off living room, screened porch off master bedroom, interior truss over living room, mudroom off entry.
	Log Home Construction Style:	Traditional Full Scribe		

Nicholson: Plan of 2nd Floor

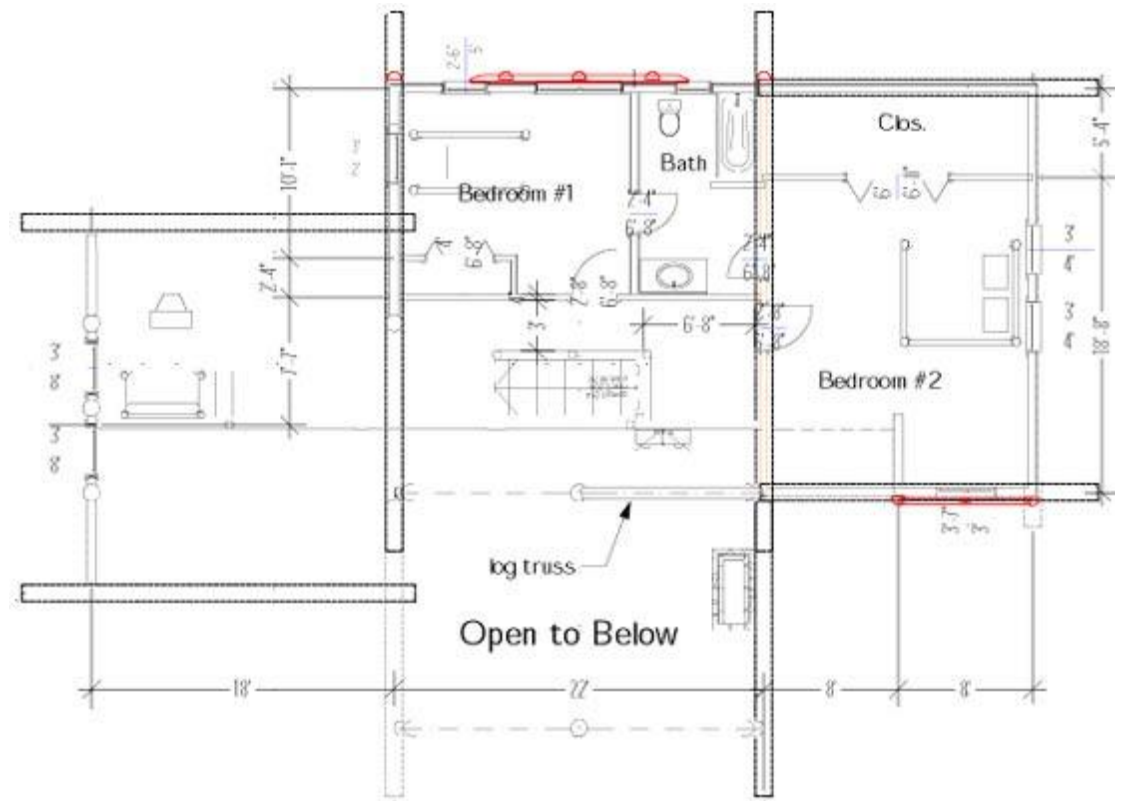

 <p>Cascade Handcrafted Log Homes</p>	Design:	Nicholson	Area:	2,700 sq ft (251 m ²)
	Designed by:	Taron Design	Features:	Sunroom off living room, screened porch off master bedroom, interior truss over living room, mudroom off entry.
	Log Home Construction Style:	Traditional Full Scribe		